

CATALOG 2015

PUMPS
SIGNAL HORNS

MATE
USA





ABOUT US

MATE GROUP and MATE USA are the brands resulted from the cooperation between **MARCO** and **TESSILMARE** and aims at achieving a leading role in the worldwide marine sector.

The international experience of both Italian manufacturers is the foundation on which **MATE GROUP** will be building its ambitious distribution plan.

MATE GROUP has been structured to meet the expectations and stimuli of the contemporary global market. New scenarios have been found to reach such goal, where technological solutions and computer means of communication can be integrated and well-balanced.

MATE GROUP stands by its clients' side as a skilled and experienced partner in the various market trends.



BILGE AND WATER TRANSFER

Completely submersible bilge pumps. Compact design with ABS material housing, corrosion resistant.
ISO 8849 and ISO 8846.

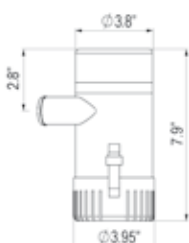

UP2000

HEAVY DUTY

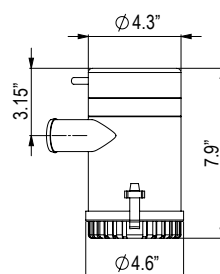

UP3700

TYPE	PART NUMBER	VOLTS	LIFT	PORTS	FLOW RATE	AMPS	FUSE	DIMENSIONS	Pcs. x carton
UP2000	M160-160-12	12	13 ft.	1-1/4"	2000 gph	12	25A	7.9" x Ø3.8"	6
	M160-160-13	24	13 ft.	1-1/4"	2000 gph	6	15A	7.9" x Ø3.8"	6
UP3700	M160-180-13	24	16 ft.	1 - 1/2"	3700 gph	6	10A	7.9" x Ø4.3"	1

Automatic float switch for bilge pumps.

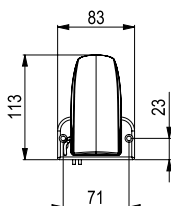

MERCURY FREE



AS2

TYPE	PART NUMBER	VOLTS	AMPS	OFF / ON	WIRE	DIMENSIONS	Pcs. x carton
AS2	M161-002-20	12	max. 10	1" / 2.2"	33.5"	4.4" x 3.2" x 2.4"	24

BILGE AND SALT WATER PUMPS

Self-priming electric pump with flexible nitrile impeller. Now available in 3 different flow rates: 7.4, 9.25 and 11.9 gpm. Fitted with water proof cable guide and internal brush holder with EMI filter. ISO 8846 and ISO 8849. Ideal for bilge, waste water and ballast tank on any type of boat.



TYPE	PART NUMBER	VOLTS	SELF-PRIMING	PRESSURE	FLOW RATE	AMPS	FUSE	PORTS	THREAD
UP1-J	M162-004-12	12	5 ft	14.5 psi	7.4 gpm	8	10 amps	3/4"	3/8" BSP
	M162-004-13	24	5 ft	14.5 psi	7.4 gpm	4	7.5 amps	3/4"	3/8" BSP
UP1-N	M162-002-12	12	5 ft	17.4 psi	9.2 gpm	10	20 amps	1"	1/2" BSP
	M162-002-13	24	5 ft	17.4 psi	9.2 gpm	5	15 amps	1"	1/2" BSP
UP1-M	M162-006-12	12	5 ft	21.8 psi	11.9 gpm	14	20 amps	1"	1/2" BSP
	M162-006-13	24	5 ft	21.8 psi	11.9 gpm	7	15 amps	1"	1/2" BSP

ELECTRONIC WATER SYSTEM PUMPS



Self-priming automatic electric pumps with helical PTFE gears, integrated check valve and electronic control. Nickel-plated brass body and stainless steel shaft. Control panel available.

Main applications: fresh water pressure systems and shower kits on boats, sailing boats and campers. Available also in 13.8 gpm, 17.5 gpm and 21.1 gpm.

Advantages:

- Constant control of pressure, current and voltage.
- The motor gradually runs to reach the required flow rate.
- There is no need for an accumulator tank.
- The electronic system tries to re-start the motor 4 times.
- Green/Red LED signals pump functions.
- Reduction of noise, current absorbtion and mechanical wearing.
- The pump is protected against short circuits and overloads.
- There is no need for a fuse.
- Blue flashing LED indicates empty tank.

VARIABLE SPEED



UP2/E



UP3/E



**EMPTY TANK
AUTOMATIC
STOP**

UP6/E



UP12/E



TYPE	PART NUMBER	VOLTS	SELF-PRIMING	PRESSURE	FLOW RATE	AMPS	FUSE	PORTS (male)
UP2/E	M164-660-15	12/24	3.3 ft	29 psi	2.6 gpm	3/1.5	7.5 amps	3/8" NPT
UP3/E	M164-602-15	12/24	4.9 ft	36 psi	4 gpm	5/2.5	15 amps	3/8" NPT
UP6/E	M164-622-15	12/24	6.6 ft	36 psi	6.9 gpm	9/4.5	20 amps	1/2" NPT
UP12/E	M164-681-12	12	9.8 ft	43.5 psi	10.5 gpm	19	30 amps	1/2" NPT
	M164-681-13	24	9.8 ft	43.5 psi	10.5 gpm	10	20 amps	1/2" NPT

DIESEL TRANSFER GEAR PUMPS

Compact and professional self-priming electric pumps with bronze gears for transferring of liquids. Pump body in nickel-plated brass and stainless steel shaft.

Main applications: transfer of diesel fuel and antifreeze.

**HIGH
SPEED**

UP2



UP3



UP6



UP12



TYPE	PART NUMBER	VOLTS	SELF-PRIMING	PRESSURE	FLOW RATE	AMPS	FUSE	PORTS (male)
UP2	M164-200-12	12	4.9 ft	22 psi	2.6 gpm	2.8 - 3.2	5 amps	3/8" NPT
	M164-200-13	24	4.9 ft	22 psi	2.6 gpm	1.4 - 1.6	3 amps	3/8" NPT
UP3	M164-000-12	12	4.9 ft	29 psi	4 gpm	5 - 6	10 amps	3/8" NPT
	M164-000-13	24	4.9 ft	29 psi	4 gpm	3 - 4	5 amps	3/8" NPT
UP6	M164-060-12	12	4.9 ft	29 psi	6.87 gpm	9 - 11	15 amps	1/2" NPT
	M164-060-13	24	4.9 ft	29 psi	6.87 gpm	5 - 6	7.5 amps	1/2" NPT
UP12	M164-300-12	12	13.1 ft	36 psi	10.5 gpm	20	30 amps	1/2" NPT
	M164-300-13	24	13.1 ft	36 psi	10.5 gpm	11	15 amps	1/2" NPT

110V & 220V PUMPS



Self-priming electric pumps with gears for transferring of fuel and oils. Nickel-plated brass body and shaft in stainless steel AISI 420. Voltage available 110V and 220V single phase.

For 110V items minimum order quantity required.

UP1/AC



UP3/AC



UP6/AC



VP45/AC

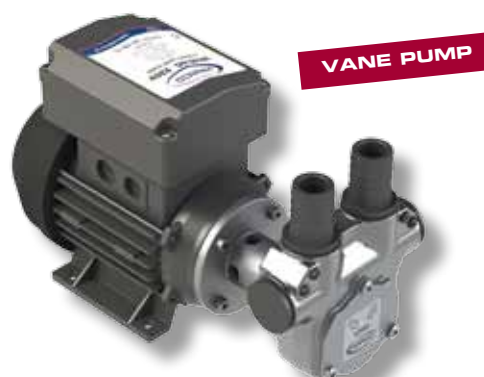

TYPE	PART NUMBER	VOLTS	SELF-PRIMING	PRESSURE max.	FLOW RATE max.	AMPS	MOTOR	FUSE	PORTS	THREAD
UP1/AC	M162-001-1B	110	4.9 ft	14.5 psi	9.5 gpm	6.6	550W	8 amps	1"	1/2" BSP
	M162-001-1C	220	4.9 ft	14.5 psi	7.9 gpm	3.3	550W	4 amps	1"	1/2" BSP
UP3/AC	M164-001-1B	110	4.9 ft	87 psi	3.2 gpm	1.6	150W	2.5 amps	1/2"	3/8" NPT
	M164-001-1C	220	4.9 ft	87 psi	2.64 gpm	0.8	150W	1.25 amps	1/2"	3/8" NPT
UP6/AC	M164-061-1B	110	4.9 ft	58 psi	8.9 gpm	4.4	550W	5 amps	5/8"	1/2" NPT
	M164-061-1C	220	4.9 ft	58 psi	7.4 gpm	2.2	550W	2.5 amps	5/8"	1/2" NPT
VP45/AC	M166-030-1B	110	4.9 ft	17.4 psi	11.1 gpm	0.6	150W	2.5 amps	1"	---
	M166-030-1C	220	4.9 ft	17.4 psi	9.25 gpm	0.3	150W	1.25 amps	1"	---

DIESEL REFUELING VANE PUMPS



Self-priming electric vane pump with integrated by-pass valve. Aluminium body. Multiple quick-fit connections for 1" pipe. Rotor and vanes made of resin. Has brush holder with EMI filter, On/Off switch and battery clips.

Main applications: diesel, oil and antifreeze transfer. Available also with case and handle for easy transport.

VP45-K



VP45-N



VP45

TYPE	PART NUMBER	VOLTS	SELF-PRIMING	PRESSURE	FLOW RATE	AMPS	FUSE	PORTS (male)
VP45-K	M166-024-12	12	4.9 ft	17.4 psi	11.9 gpm	8 - 19	20 amps	1"
	M166-024-13	24	4.9 ft	17.4 psi	11.9 gpm	4 - 9.5	10 amps	1"
VP45-N	M166-026-12	12	4.9 ft	17.4 psi	11.9 gpm	8 - 19	20 amps	1"
	M166-026-13	24	4.9 ft	17.4 psi	11.9 gpm	4 - 9.5	10 amps	1"
VP45	M166-020-12	12	4.9 ft	17.4 psi	11.9 gpm	8 - 19	20 amps	1"
	M166-020-13	24	4.9 ft	17.4 psi	11.9 gpm	4 - 9.5	10 amps	1"

OIL TRANSFER GEAR PUMPS

Self-priming electric pumps with helical bronze gears for transferring lubricating oils and viscous liquids. Nickel-plated brass body and stainless steel shaft.

Main applications: draining engine sumps and lubricating engines.

**LOW
SPEED**



UP2/OIL



UP3/OIL



UP6/OIL



UP12/OIL



TYPE	PART NUMBER	VOLTS	SELF-PRIMING	FLOW RATE (OIL SAE 30 AT 77°F)	AMPS	FUSE	PORTS (male)
UP2/OIL	M164-220-12	12	3.3 ft	52.9 gph	2.3 - 2.7	3 amps	3/8" NPT
	M164-220-13	24	3.3 ft	52.9 gph	1.1 - 1.4	1.5 amps	3/8" NPT
UP3/OIL	M164-020-12	12	3.3 ft	87.20 gph	5.5 - 6.5	7.5 amps	3/8" NPT
	M164-020-13	24	3.3 ft	87.20 gph	2.5 - 3.5	4 amps	3/8" NPT
UP6/OIL	M164-080-12	12	4.9 ft	126.82 gph	6.5 - 8.5	10 amps	3/8" NPT
	M164-080-13	24	4.9 ft	126.82 gph	3.5 - 4.5	7.5 amps	3/8" NPT
UP12/OIL	M164-320-12	12	6.6 ft	238 gph	11 - 12	15 amps	1/2" NPT
	M164-320-13	24	6.6 ft	238 gph	5.5 - 6.5	7.5 amps	1/2" NPT

ON/OFF INTEGRATED SWITCH PUMPS WITH REVERSING OPTION



Self-priming electric pumps for the refueling and transfer of diesel, oil and water with ON/OFF switch integrated into the water-proof cap.

The R versions are fitted with a 3-position switch for reversing the flow direction.

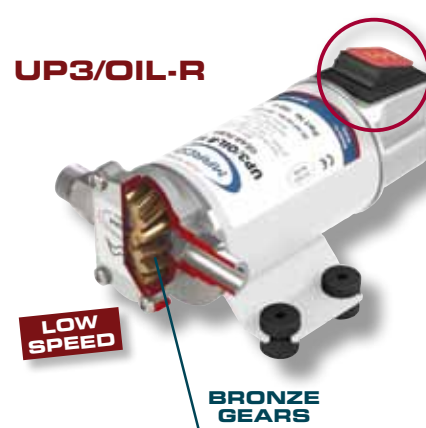
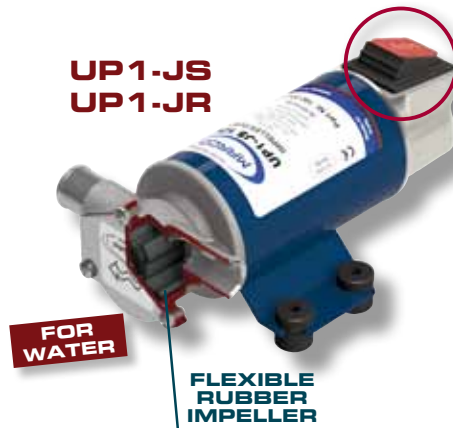
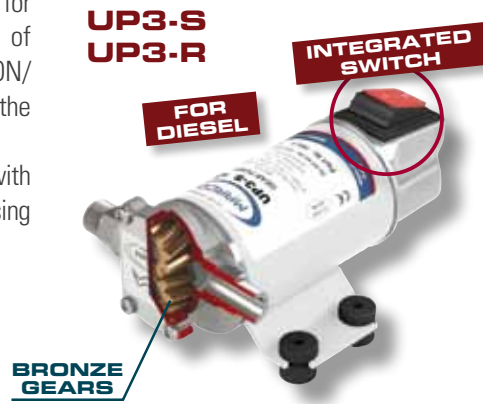

TYPE	PART NUMBER	VOLTS	SELF-PRIMING	PRESSURE	FLOW RATE	AMPS	FUSE	PORTS (male)	THREAD
UP1-JS	M162-010-12	12	5 ft	14.5 psi	7.4 gpm	8	10 amps	3/4"	3/8" BSP
	M162-010-13	24	5 ft	14.5 psi	7.4 gpm	4	7.5 amps	3/4"	3/8" BSP
UP1-JR	M162-011-12	12	5 ft	14.5 psi	7.4 gpm	8	10 amps	3/4"	3/8" BSP
	M162-011-13	24	5 ft	14.5 psi	7.4 gpm	4	7.5 amps	3/4"	3/8" BSP
UP3-S	M164-007-12	12	3.3 ft	29 psi	4 gpm	5 - 6	10 amps	3/8" NPT	---
	M164-007-13	24	3.3 ft	29 psi	4 gpm	3 - 4	5 amps	3/8" NPT	---
UP3-R	M164-008-12	12	3.3 ft	29 psi	4 gpm	5 - 6	10 amps	3/8" NPT	---
	M164-008-13	24	3.3 ft	29 psi	4 gpm	3 - 4	5 amps	3/8" NPT	---
VP45-S	M166-028-12	12	5 ft	17.4 psi	11.9 gpm	8 - 19	20 amps	1"	---
	M166-028-13	24	5 ft	17.4 psi	11.9 gpm	4 - 9.5	10 amps	1"	---

TYPE	PART NUMBER	VOLTS	SELF-PRIMING	FLOW RATE			AMPS	FUSE	PORTS (male)
				6mm	8mm	13mm			
UP3/OIL-R	M164-022-12	12	3.3 ft	5.30 gph	15.90 gph	87.20 gph	5.5 - 6.5	7.5 amps	3/8" NPT
	M164-022-13	24	3.3 ft	5.30 gph	15.90 gph	87.20 gph	2.5 - 3.5	4 amps	3/8" NPT

OIL & DIESEL TRANSFER KITS

Compact size oil change kits. Easy to operate and carry. Reversible: drains and fills oil and diesel. Complete with bronze gear pump, clips, fuse, hoses and accessories.

OCK1-E

FOR OIL & DIESEL



ELECTRONIC & REVERSIBLE

Electronic control panel and 12/24V universal voltage. Variable speed of the motor proportional to the liquid viscosity. Suitable for oil and diesel.

OCK1

LOW SPEED REVERSIBLE



Oil change kit with manual control, 12V or 24V. Reversible: drains and fills oils.

OCK1-R

LOW SPEED REVERSIBLE



Compact size oil change kit with integrated 3-position switch for flow reversibility.

UP3-CK

HIGH SPEED FOR DIESEL



Self-priming electric pump with bronze gears for diesel transfer. Complete with On/Off switch, cable with integrated fuse and battery clips.

TYPE	PART NUMBER	VOLTS	SELF-PRIMING	FLOW RATE			AMPS	FUSE	PORTS (male)	THREAD
				1/4"	5/16"	15/32"				
OCK1	M164-930-12	12	3.3 ft	5.30 gph	15.90 gph	87.20 gph	5.5 - 6.5	7.5 amps	1/2"	3/8" BSP
	M164-930-13	24	3.3 ft	5.30 gph	15.90 gph	87.20 gph	5.5 - 6.5	4 amps	1/2"	3/8" BSP
OCK1-E	M164-931-15	12/24	3.3 ft	9.25 gph	29 gph	158.5 gph	max 6	7.5 amps	1/2"	3/8" BSP
OCK1-R	M164-932-12	12	3.3 ft	5.30 gph	15.90 gph	87.20 gph	5.5 - 6.5	7.5 amps	1/2"	3/8" BSP
	M164-932-13	24	3.3 ft	5.30 gph	15.90 gph	87.20 gph	5.5 - 6.5	4 amps	1/2"	3/8" BSP
UP3-CK	M164-006-12	12	4.9 ft		4 gpm max.		5 - 6	10 amps	1/2"	3/8" BSP
	M164-006-13	24	4.9 ft		4 gpm max.		3 - 4	5 amps	1/2"	3/8" BSP

REVERSIBLE OIL & DIESEL PUMPS

Pumps for oil and diesel filling and draining with electronic controls. The touchpad electronic sensor adjusts the speed of the motor according to the liquid viscosity and temperature. Compact design fits in any engine room. Automatic shut-off for empty tank and short circuit. System will shut-off after 30 minutes of operation. Fittings with 1 or 2 valves available.



TYPE	PART NUMBER
OCP1/3	M165-030-00
 <div>3/8" valve</div>	

TYPE	PART NUMBER
OCP1/6	M165-032-00
 <div>1/2" valve</div>	

TYPE	PART NUMBER
OCP2/3	M165-031-00
 <div>Two 3/8" valves and 1 NPT fitting</div>	

TYPE	PART NUMBER
OCP2/6	M165-033-00
 <div>Two 1/2" valves and 1 NPT fitting</div>	

TYPE	PART NUMBER	VOLTS	SELF-PRIMING	PORTS (male)	FLOW RATE	AMPS
UP3-RK	M164-005-15	12/24	4.9 ft	3/8" NPT	4 gpm	4 / 2
UP6-RK	M164-064-15	12/24	4.9 ft	1/2" NPT	6.9 gpm	5 / 2.5

OIL CHANGE SYSTEMS

Compact, easy to use oil change system for fixed installations that eliminates leaks. Used for oil filling and draining operations. Applications include generators, engines, transmissions and catwalks. The touchpad electronic sensor adjusts the speed of the motor according to the oil viscosity and temperature and increases the system speed during priming. Automatic shut-off for empty tank and short circuit. System will shut-off after 30 minutes of operation.



OCS3/E



OCS5/E



OCS6/E



OCS9/E



TYPE	PART NUMBER	VOLTS	SELF-PRIMING	PORTS (male)	FLOW RATE	AMPS
OCS3/E	M164-924-15	12/24	4.9 ft	1/2" NPT	2.6 gpm	4 / 2
OCS5/E	M164-925-15	12/24	4.9 ft	1/2" NPT	2.6 gpm	4 / 2
OCS6/E	M164-926-15	12/24	4.9 ft	1/2" NPT	4 gpm	5 / 2.5
OCS9/E	M164-928-15	12/24	4.9 ft	1/2" NPT	4 gpm	5 / 2.5
	M164-928-1H	110/220	4.9 ft	1/2" NPT	4 gpm	0.6 / 0.3

IMO/USCG APPROVED HORNS

12-20 m (40-65 ft)

Approved signaling whistle complete with chromed or white horn Ø200mm, electric compressor and mounting accessories.

Meets COLREG 1972 IMO class IV regulations.

Approvals: NMMA ABYC A-23, RINA, LLOYD'S REGISTER MCA, BUREAU VERITAS.



PW2-BB



PW2-BC



PW2



TYPE	PART NUMBER	VOLTS	AMPS	dB (1/3 OCT.) (1 m)	Hz	DIMENSIONS	Pcs. x carton
PW2	M150-000-12	12	20	123	315	18.1" x Ø7.9"	1
	M150-000-13	24	10	123	315	18.1" x Ø7.9"	1
PW2-BC	M150-002-12	12	20	123	315	17.7" x Ø7.9"	1
	M150-002-13	24	10	123	315	17.7" x Ø7.9"	1
PW2-BB	M150-003-12	12	20	123	315	17.7" x Ø7.9"	1
	M150-003-13	24	10	123	315	17.7" x Ø7.9"	1

Spare parts and accessories



Type
Part Nr. **M1-W
MR50-000-33**
12V Compressor



Type
Part Nr. **M1-W
MR50-000-34**
24V Compressor



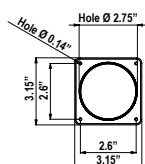
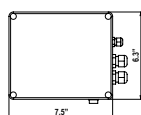
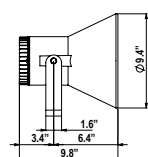

IMO/USCG APPROVED HORNS

12-20 m (40-65 ft)

Approved electronic whistle complete with loudspeaker, built-in touchpad control panel and electronic controller. New ultrasonic heating system for improved acoustic membrane performance. Meets COLREG 1972 IMO class IV international regulations with NMMA ABYC A-23, RINA, LLOYD'S REGISTER MCA, BUREAU VERITAS, and BSH homologations. Includes mounting kit.



TYPE	PART NUMBER	VOLTS	AMP.	dB (1/3 OCT.) (1 m)	Hz	DIMENSIONS	Pcs. x carton
EW2	M150-040-12	12	3	122	675	9.8"x9.3"	1
	M150-040-13	24	1,5	122	675	9.8"x9.3"	1
EW2-M	M150-041-12	12	3	122	675	9.8"x9.3"	1
	M150-041-13	24	1,5	122	675	9.8"x9.3"	1
EW2-MS	M150-044-12	12	3	122	675	9.8"x9.3"	1
	M150-044-13	24	1,5	122	675	9.8"x9.3"	1

Available functions		HORN	FOG	VHF INPUT	MICROPHONE	SIREN
TYPE	PART NUMBER					
EW2	M150-040-12	•	•			
	M150-040-13	•	•			
EW2-M	M150-041-12	•	•	•	•	
	M150-041-13	•	•	•	•	
EW2-MS	M150-044-12	•	•	•	•	•
	M150-044-13	•	•	•	•	•

IMO/USCG APPROVED HORNS

20-75 m (65-246 ft)

Approved whistle complete with chromed or white horn Ø 300 mm. Electric valve and mounting accessories, for compressed air operation 6/12 bar. Meets COLREG 1972 IMO class III regulations. Approvals: NMMA ABYC A-23, RINA, LLOYD'S REGISTER MCA, BUREAU VERITAS.



PW3-BB



PW3-BC



PW3



TYPE	PART NUMBER	VOLTS	AMP.	dB (1/3 OCT.) (1 m)	Hz	DIMENSIONS	Pcs. x carton
PW3	M152-000-12	12	4,5	132	315	18.1"xØ11.8"	1
	M152-000-13	24	2,5	132	315	18.1"xØ11.8"	1
PW3-BC	M152-002-12	12	4,5	132	315	17.9"xØ11.8"	1
	M152-002-13	24	2,5	132	315	17.9"xØ11.8"	1
PW3-BB	M152-003-12	12	4,5	132	315	17.9"xØ11.8"	1
	M152-003-13	24	2,5	132	315	17.9"xØ11.8"	1

Spare parts
and accessories

Type
Part Nr.
M3
M135-100-12
12V Compressor

Type
Part Nr.
M3
M135-100-13
24V Compressor

IMO/USCG APPROVED HORNS

20-75 m (65-246 ft)

Approved electronic whistle complete with loudspeaker, built-in touchpad control panel and electronic controller. New ultrasonic heating system for improved acoustic membrane performance. Meets COLREG 1972 IMO class IV international regulations with NMMA ABYC A-23, RINA, LLOYD'S REGISTER MCA, BUREAU VERITAS, and BSH homologations. Includes mounting kit.

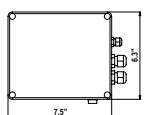
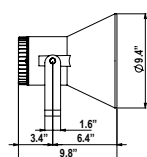

TYPE	PART NUMBER	VOLTS	AMP.	dB (1/3 OCT.) (1 m)	Hz	DIMENSIONS	Pcs. x carton
EW3	M152-063-13	24	4	131	690	16.6"x12.5"	1
EW3-M	M152-060-13	24	4	131	690	16.6"x12.5"	1
EW3-MS	M152-064-13	24	4	131	690	16.6"x12.5"	1

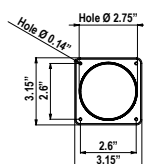

Available functions		HORN	FOG	VHF INPUT	MICROPHONE	SIREN
TYPE	PART NUMBER					
EW3	M152-063-13	•	•			
EW3-M	M152-060-13	•	•	•	•	
EW3-MS	M152-064-13	•	•	•	•	•

HORNS & WHISTLES



SK 1 SK 1/C

Electromagnetic horn for small boats. High impact casing in chromed or white ASA. Mounting bracket in AISI 304 stainless steel. Excellent drainage system.

SK 1



SK 1/C



TYPE	PART NUMBER	VOLTS	DIMENSIONS	dB (A) (3.3 ft)	Hz	AMPS
SK1	M132-081-22	12	38.5" x 39" x 55.5"	108	400	5
SK1/C	M132-082-22	12	38.5" x 39" x 55.5"	108	400	5

SM 1 SM 1/C

Internally mounted electromagnetic horn for small rubber and sailing boats. Body in chromed or white ASA. UV resistant. Grille in white or chromed ASA with snap-on system.

SM 1



SM 1/C



TYPE	PART NUMBER	VOLTS	DIMENSIONS	dB (A) (3.3 ft)	Hz	AMPS
SM1	M132-101-22	12	46" x 35" x 43.5"	108	400	5
SM1/C	M132-102-22	12	46" x 35" x 43.5"	108	400	5

EMX 1 EMX 2 EMX 1/2

Single or double electromagnetic horn with stainless steel trumpet, bracket and membrane. New support design with integrated cable. Complete with fixing hardware.

EMX 1



EMX 2

EMX 1/2



TYPE	PART NUMBER	VOLTS	DIMENSIONS	dB (A) (3.3 ft)	Hz	AMPS
EMX1	M132-043-22	12	185"	119	340	6
	M132-043-23	24	185"	119	340	3
EMX2	M132-042-22	12	157.5"	119	370	6
	M132-042-23	24	157.5"	119	370	3
EMX1/2	M132-061-22	12	157.5"/185"	122	340/370	12
	M132-061-23	24	157.5"/185"	122	340/370	6

HORNS & WHISTLES



HR1 HR1/C

Enclosure type electro-pneumatic horn for boats with integrated compressor. ASA grille and steel bracket. Extremely powerful.



TYPE	PART NUMBER	VOLTS	DIMENSIONS	dB (A) (3.3 ft)	Hz	AMPS
HR1	M134-080-12	12	38.5" x 39" x 55.5"	120	310	5
	M134-080-13	24	38.5" x 39" x 55.5"	120	310	5
HR1/C	M134-081-12	12	46" x 35" x 43.5"	120	310	5
	M134-081-13	24	46" x 35" x 43.5"	120	310	5

EMH-M EMH-MS

Multifunction electronic whistle with loudspeaker, AISI 316 stainless steel bracket and electronic unit. Waterproof. Available with the following functions: horns, automatic fog signal, VHF input, microphone and siren.



TYPE	PART NUMBER	VOLTS	PROTECTION	dB (A) (3.3 ft)	Hz	DIMENSIONS
EMH-M	M136-001-12	12	IP67	112	800	60.5" x 47.5" x 52"
	M136-001-13	24	IP67	112	800	60.5" x 47.5" x 52"
EMH-MS	M136-002-12	12	IP67	112	800	60.5" x 47.5" x 52"
	M136-002-13	24	IP67	112	800	60.5" x 47.5" x 52"

SELECTION GUIDE

Type	12V	24V	220V	110V	Flow Rate gpm	Pressure psi	Fresh Water	Salt Water	Greywater	Diesel	Oil	Submersible	Automatic	High Pressure	Electronic	Integrated Switch	Reversible	Portable Kit	Page
UP2000	•	•			33.3	5.8	•	•			•								3
UP3700		•			61.6	7.3	•	•			•								3
UP1-J	•	•			7.4	14.5	•	•	•								•		4
UP1-N	•	•			9.2	17.4	•	•	•								•		4
UP1-M	•	•			11.9	21.8	•	•	•								•		4
UP2/E	•	•			2.6	29	•	•				•		•					5
UP3/E	•	•			4	36.3	•	•				•		•					5
UP6/E	•	•			6.9	36.3	•	•				•		•					5
UP12/E	•	•			10.6	43.5	•	•				•		•					5
UP2	•	•			2.6	21.8				•							•		6
UP3	•	•			4	29				•							•		6
UP6	•	•			6.9	29				•							•		6
UP12	•	•			10.6	36.3				•							•		6
UP1/AC			•	•	7.9	14.5	•	•	•										7
UP3/AC			•	•	2.6	87				•			•						7
UP6/AC			•	•	7.4	58				•			•						7
VP45/AC			•	•	9.2	17.4				•									7
VP45-N	•	•			11.9	17.4				•									8
VP45	•	•			11.9	17.4				•								•	8
VP45-K	•	•			11.9	17.4				•								•	8
UP2/OIL	•	•			0.9	-					•						•		9
UP3/OIL	•	•			1.5	-					•						•		9
UP6/OIL	•	•			2.1	-					•						•		9
UP12/OIL	•	•			4	-					•						•		9
UP1-JS	•	•			7.4	14.5	•	•	•							•			10
UP1-JR	•	•			7.4	14.5	•	•	•							•	•		10
UP3-S	•	•			4	29				•						•			10
UP3-R	•	•			4	29				•						•	•		10
VP45-S	•	•			11.9	17.4				•						•			10
UP3/OIL-R	•	•			1.5	-					•					•	•		10
UP3-CK	•	•			4	29				•							•	•	11
OCK1	•	•			1.5	-					•						•	•	11
OCK1-R	•	•			1.5	-					•					•	•	•	11
OCK1-E	•	•			2.6	-				•	•			•			•	•	11
UP3-RK	•	•			4	29				•					•		•		12
UP6-RK	•	•			6.9	29				•					•		•		12
OCS3/E	•	•			2.6	-				•	•				•		•		13
OCS5/E	•	•			4	-				•	•				•		•		13
OCS6/E	•	•			4	-				•	•				•		•		13
OCS9/E	•	•	•	•	4	-				•	•				•		•		13



MATE USA, LLC

3251-A S.W. 13th Dr. - Deerfield Beach, FL 33442

Phone 954-463-5757 • Fax 954-463-5635

www.mate-usa.com

info@mate-usa.com

orders@mate-usa.com